

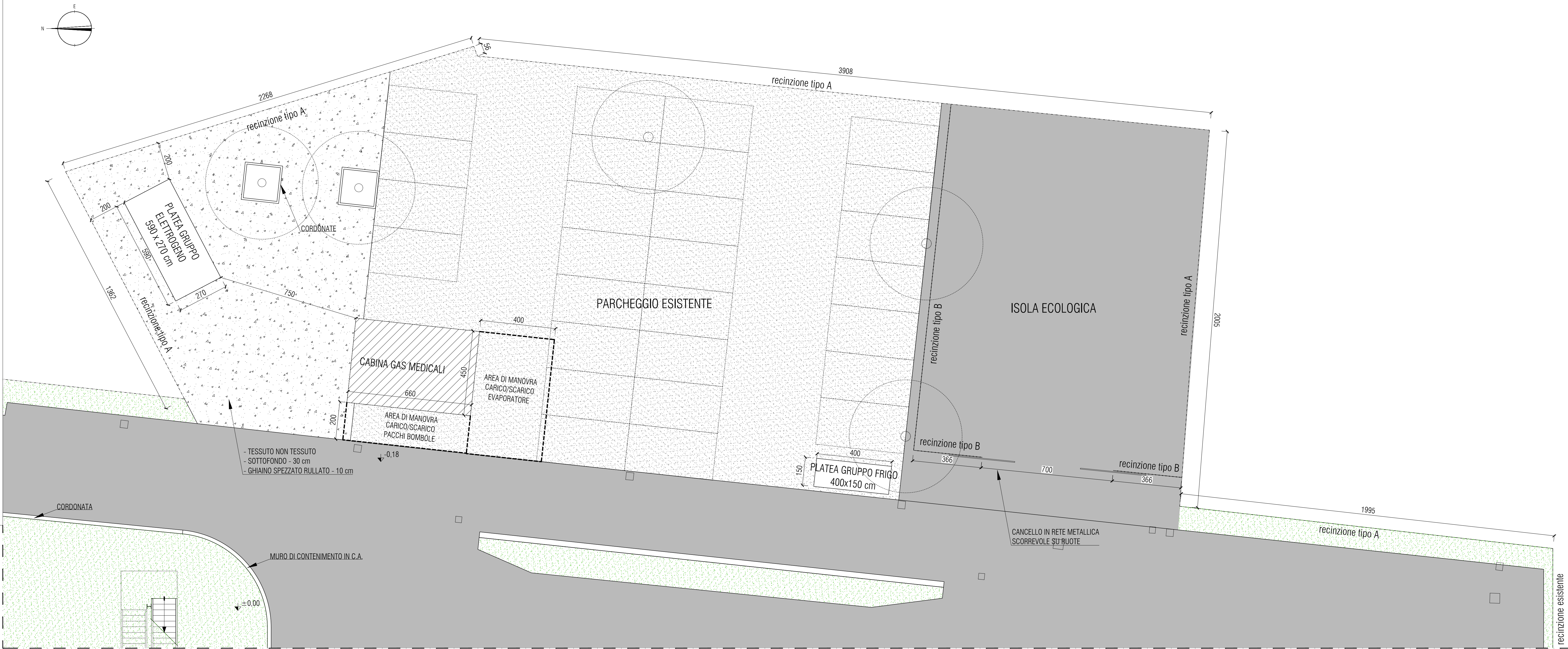





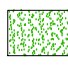

CIVITAS VITAE NAZARETH
Ristrutturazione C.S.A. "Villa Rosario"
Via Nazareth n. 38 - PADOVA (PD)

[illegible]

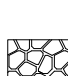
- LEGENDA SISTEMAZIONI ESTERNE**
- | | |
|---|--|
|  | Sistemazione a prato |
|  | Soletta armata con finitura in CLS colorato spazzolato |
|  | Pavimentazione in porfido opera incerta |
|  | Pavimentazione in porfido a correre |
|  | Pavimentazione in asfalto |
|  | Sistemazione con ghiaino spezzato rullato |
|  | Piatte in ghiaino su massetto in CLS |
|  | Ghiaino esistente |

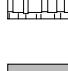

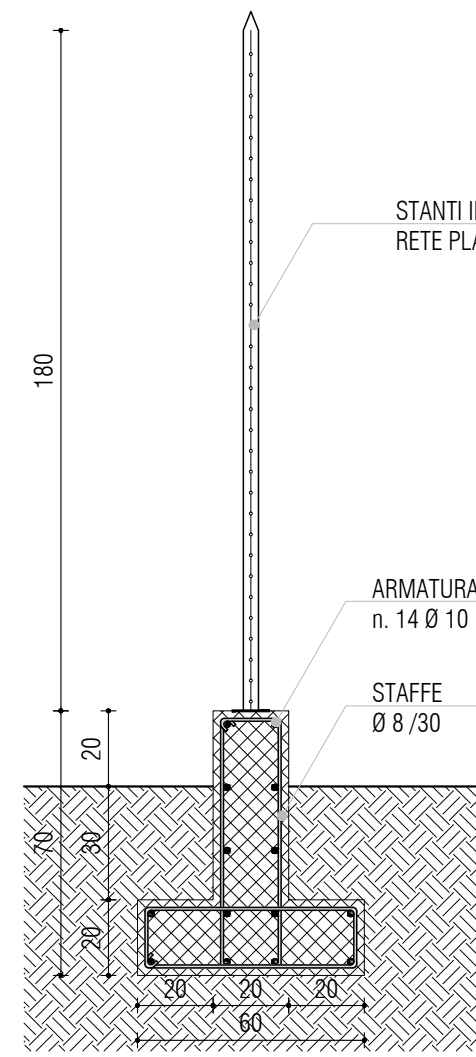
RECINZIONE TIPO A

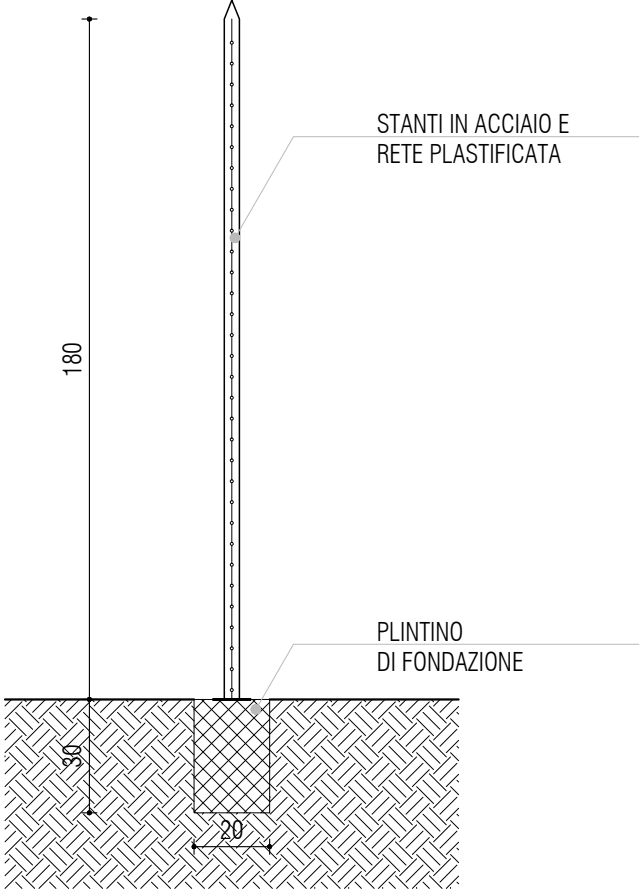

RECINZIONE TIPO B

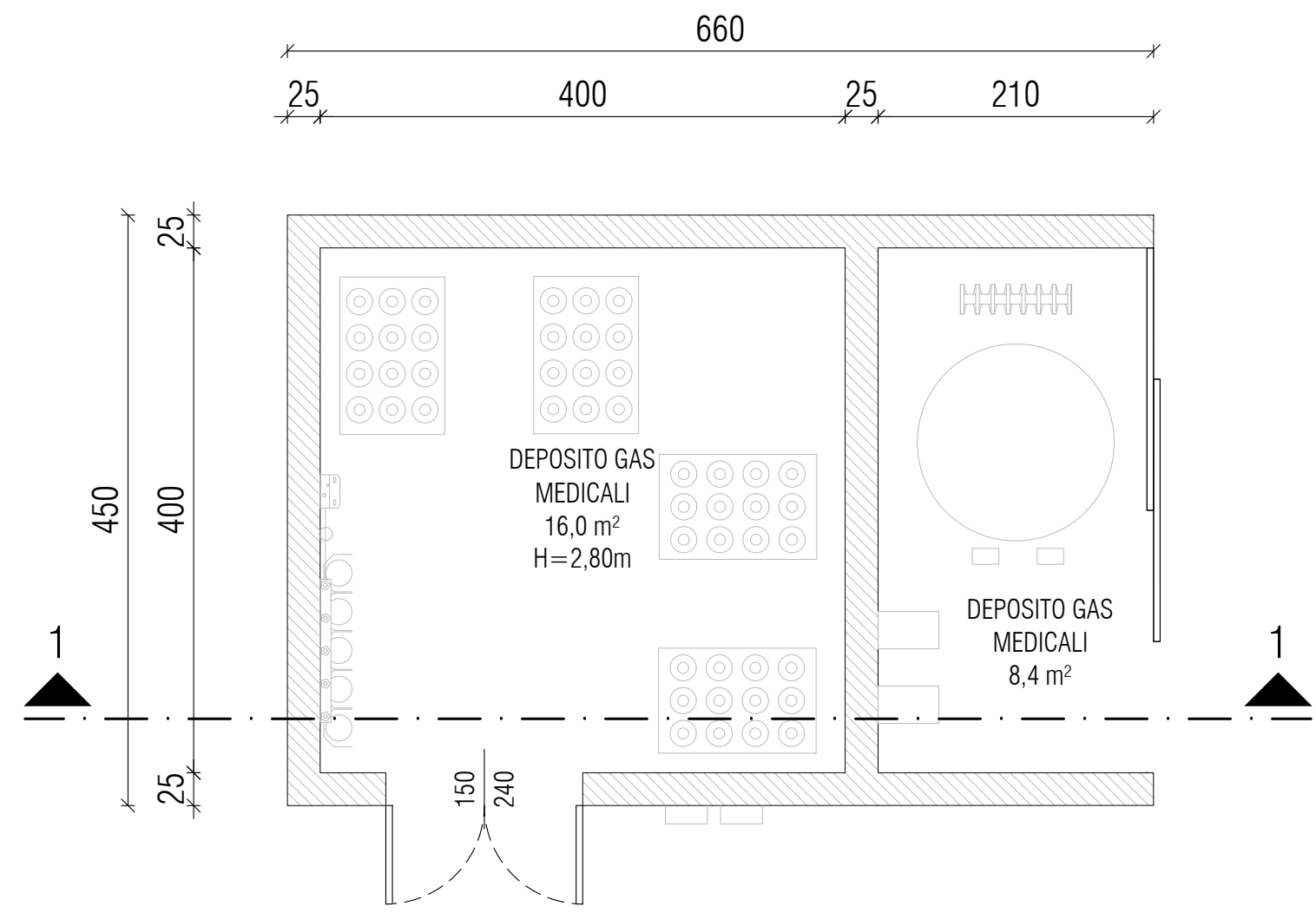

MANUFATTO GAS MEDICALI - scala 1:50

N.B. : DA VERIFICARE CON ELABORATI COSTRUTTIVI DITTA INCARICATA

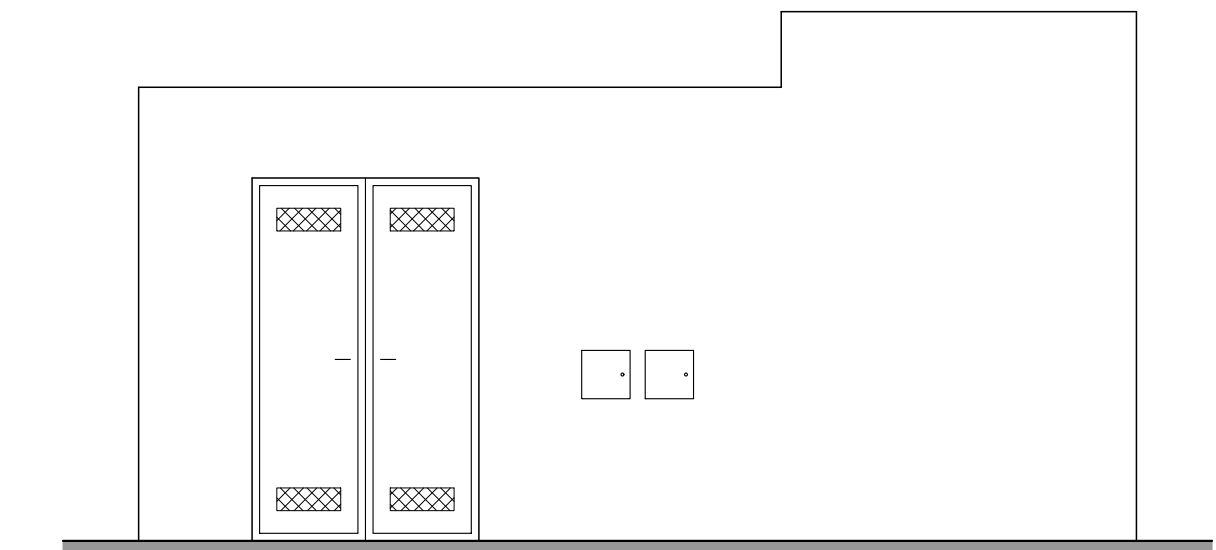

PROSPETTO OVEST - scala 1:50

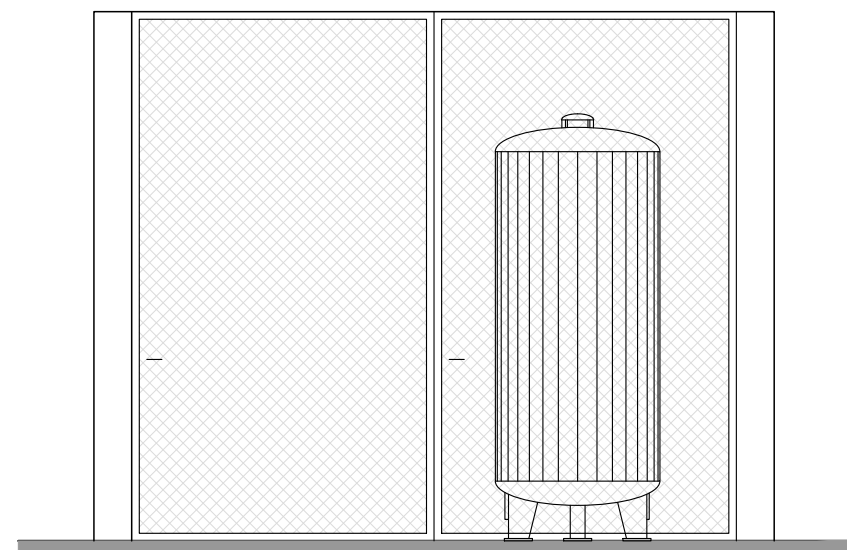

PROSPETTO SUD - scala 1:50

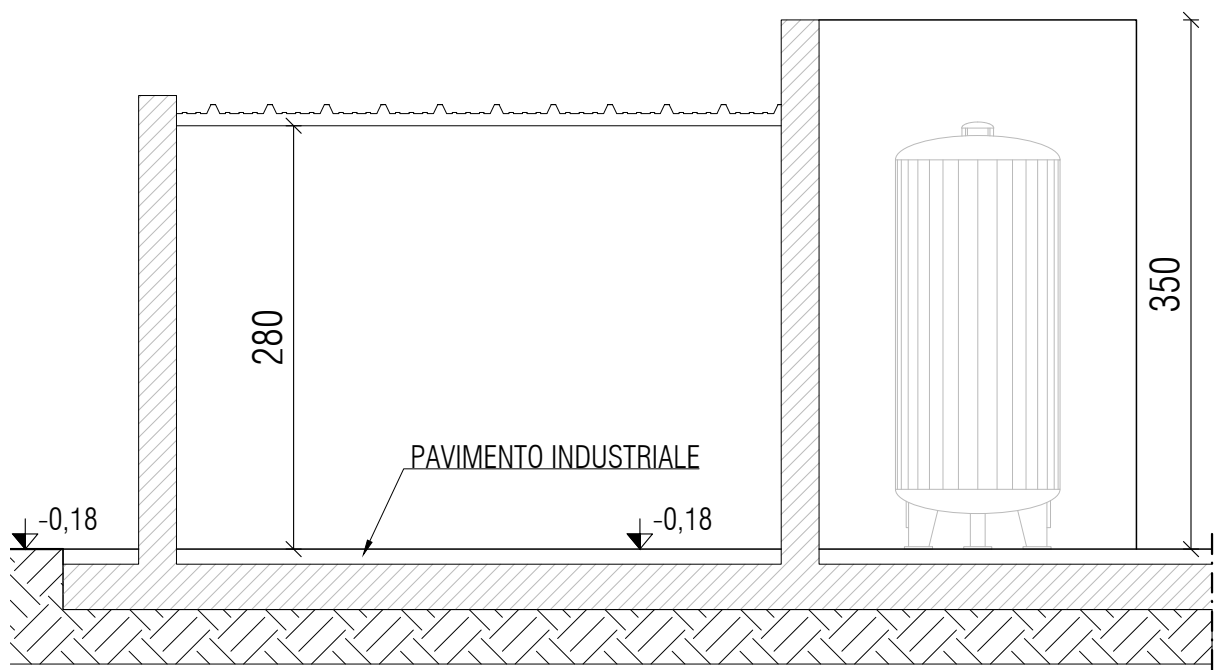

SEZIONE 1-1 - scala 1:50

- 1) L'IMPRESA DEVE VERIFICARE LA COERENZA TRA PROGETTO ARCHITETTONICO E PROGETTO STRUTTURALE SEGNALANDO PREVENTIVAMENTE LE DIFFORMITA'
- 2) VERIFICARE LE QUOTE DI IMPOSTA SOLAI E SISTEMAZIONI ESTERNE DI PROGETTO CON QUELLE ESISTENTI DELL'EDIFICIO ROSARIO
- 3) VERIFICARE PREVENTIVAMENTE LE QUOTE DELLE RETI DI SMALTIMENTO ACQUE PER UN CORRETTO DEFLUSSO